

1
PLAN DETAIL
TYPICAL DETAIL AT PORTAL
SCALE 3" = 1'-0"

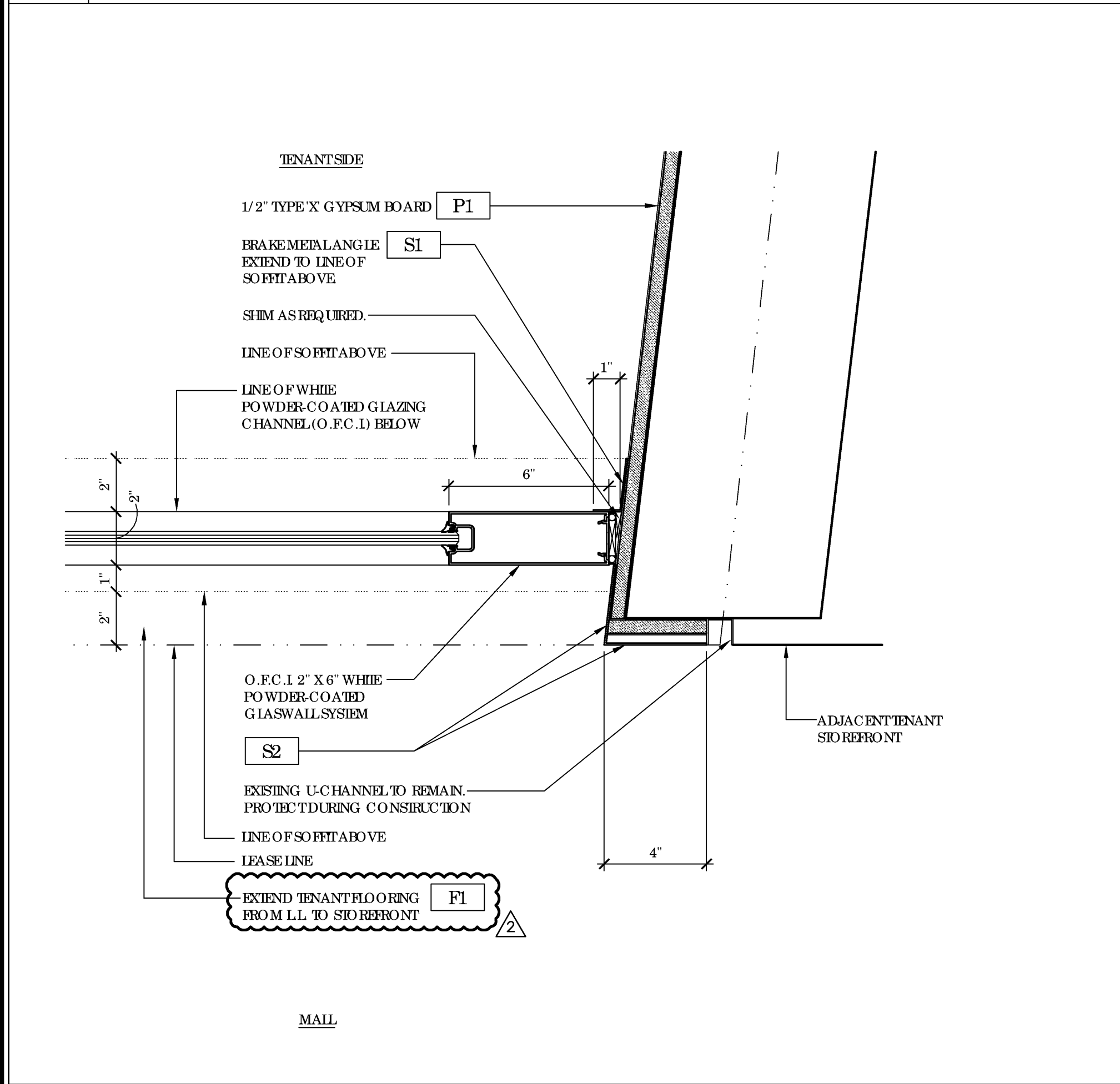

5
PLAN DETAIL
NEUTRAL PIER DETAIL
SCALE 3" = 1'-0"

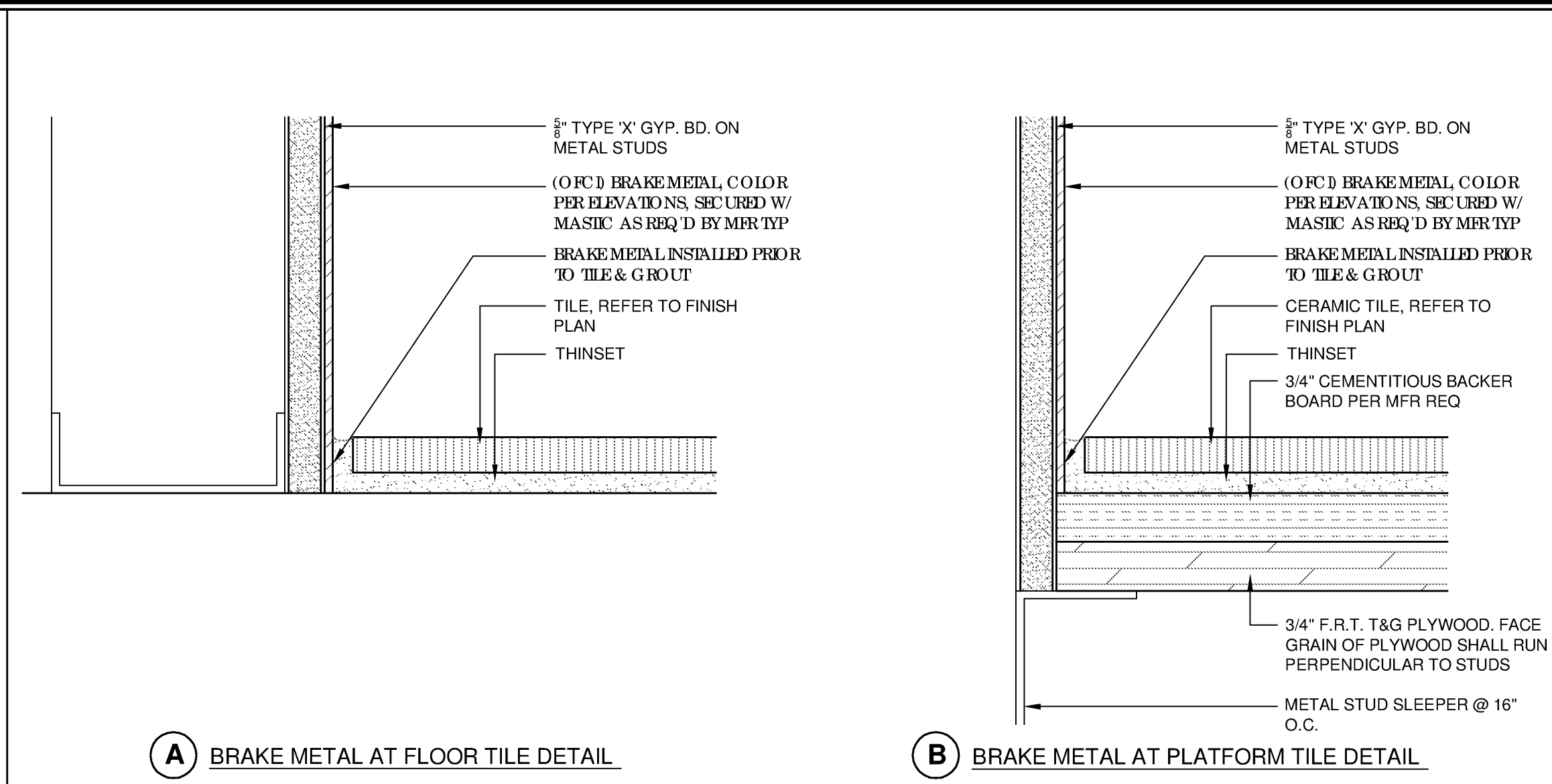

2
DETAIL
2 BRAKE METAL AT TILE DETAILS
SCALE 6" = 1'-0"

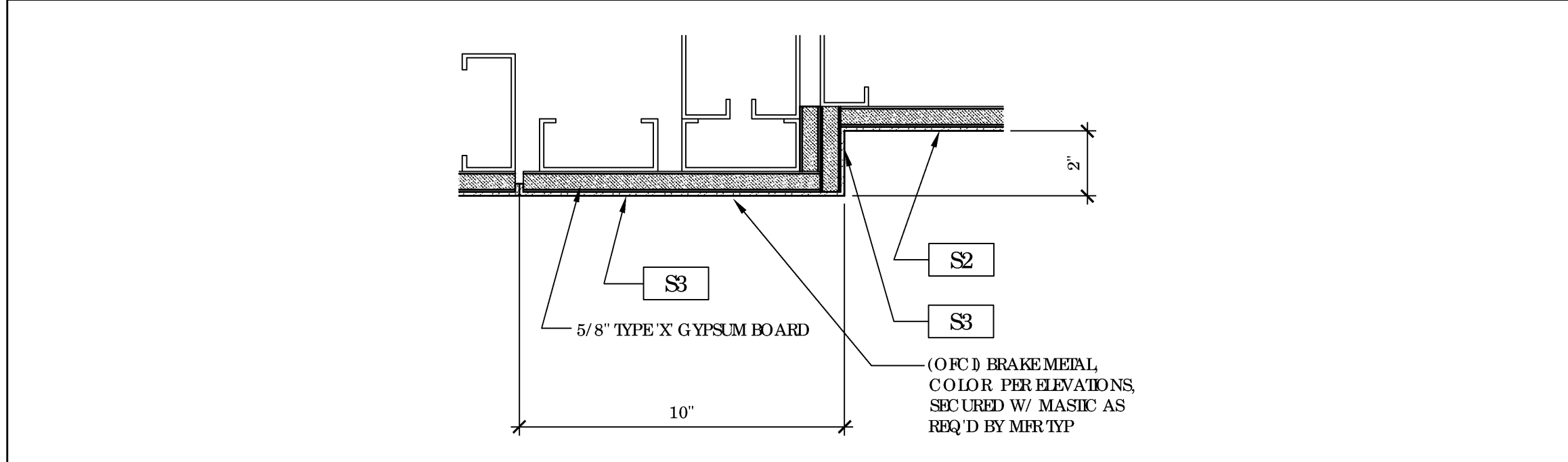

3
PLAN DETAIL
UPPER PORTAL DETAIL
SCALE 3" = 1'-0"

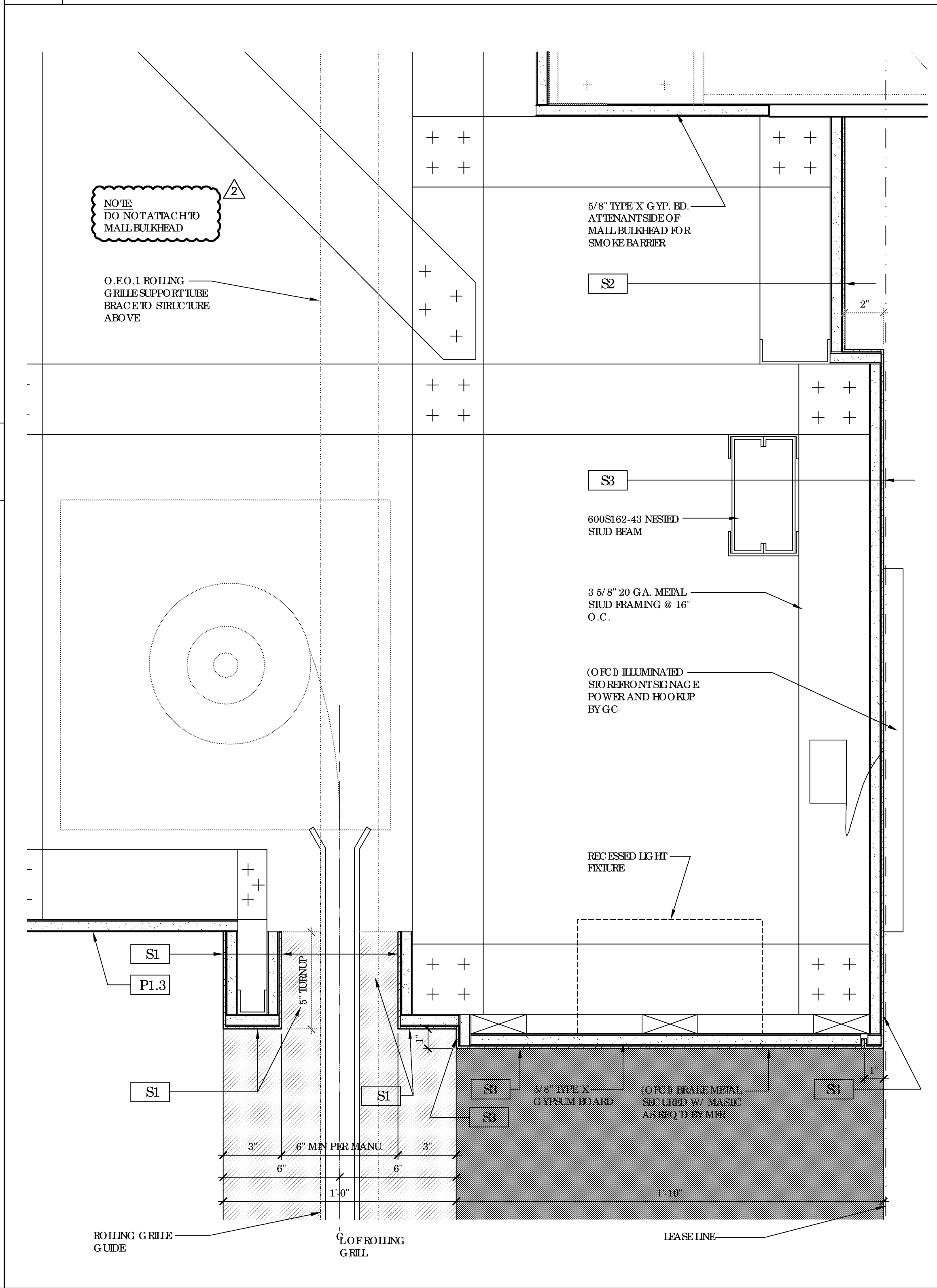

6
SECTION DETAIL
DETAIL AT ROLLING GRILLE
SCALE 3" = 1'-0"

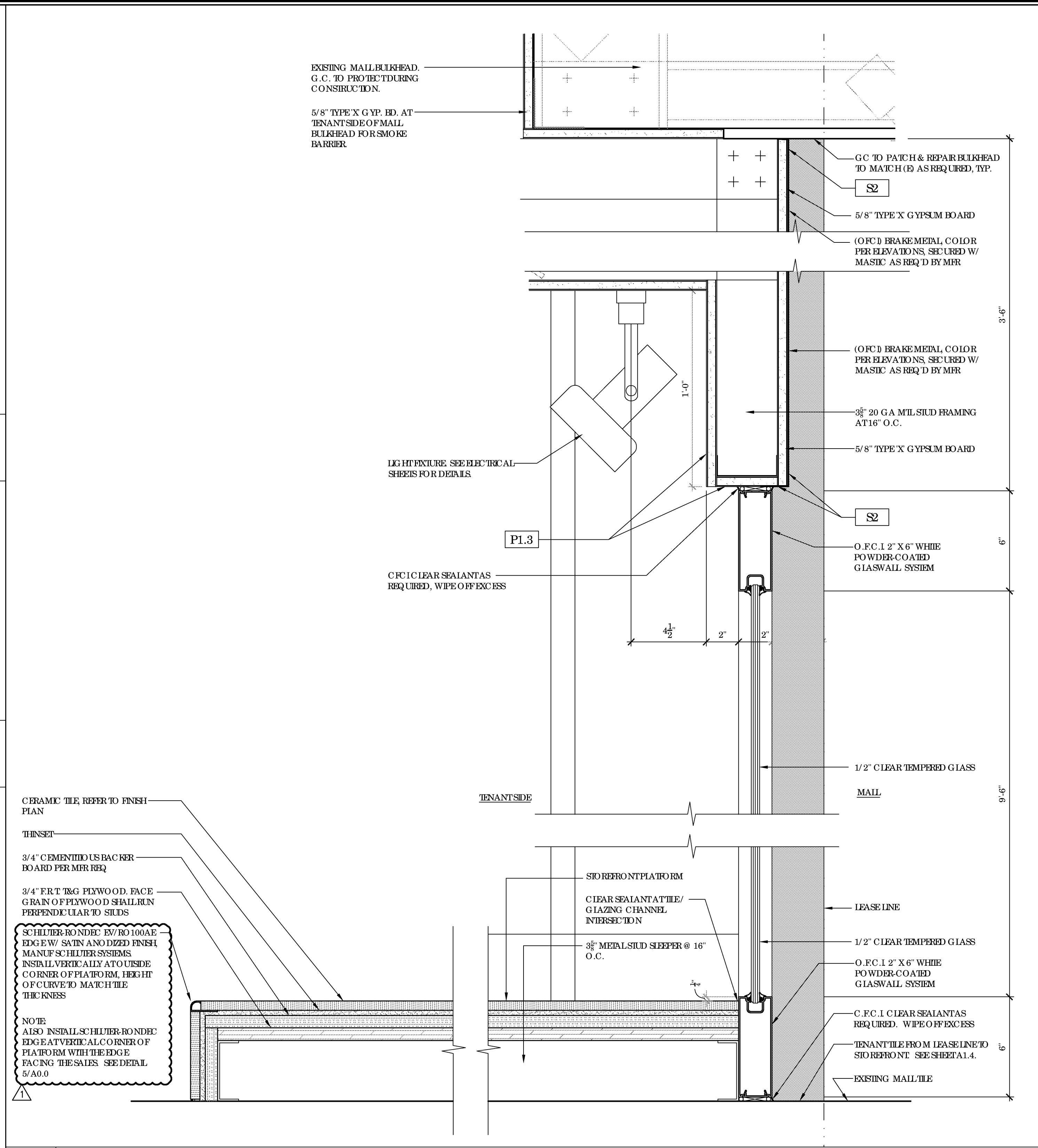

4
SECTION DETAIL
STOREFRONT HEAD AND BASE
SCALE 3" = 1'-0"

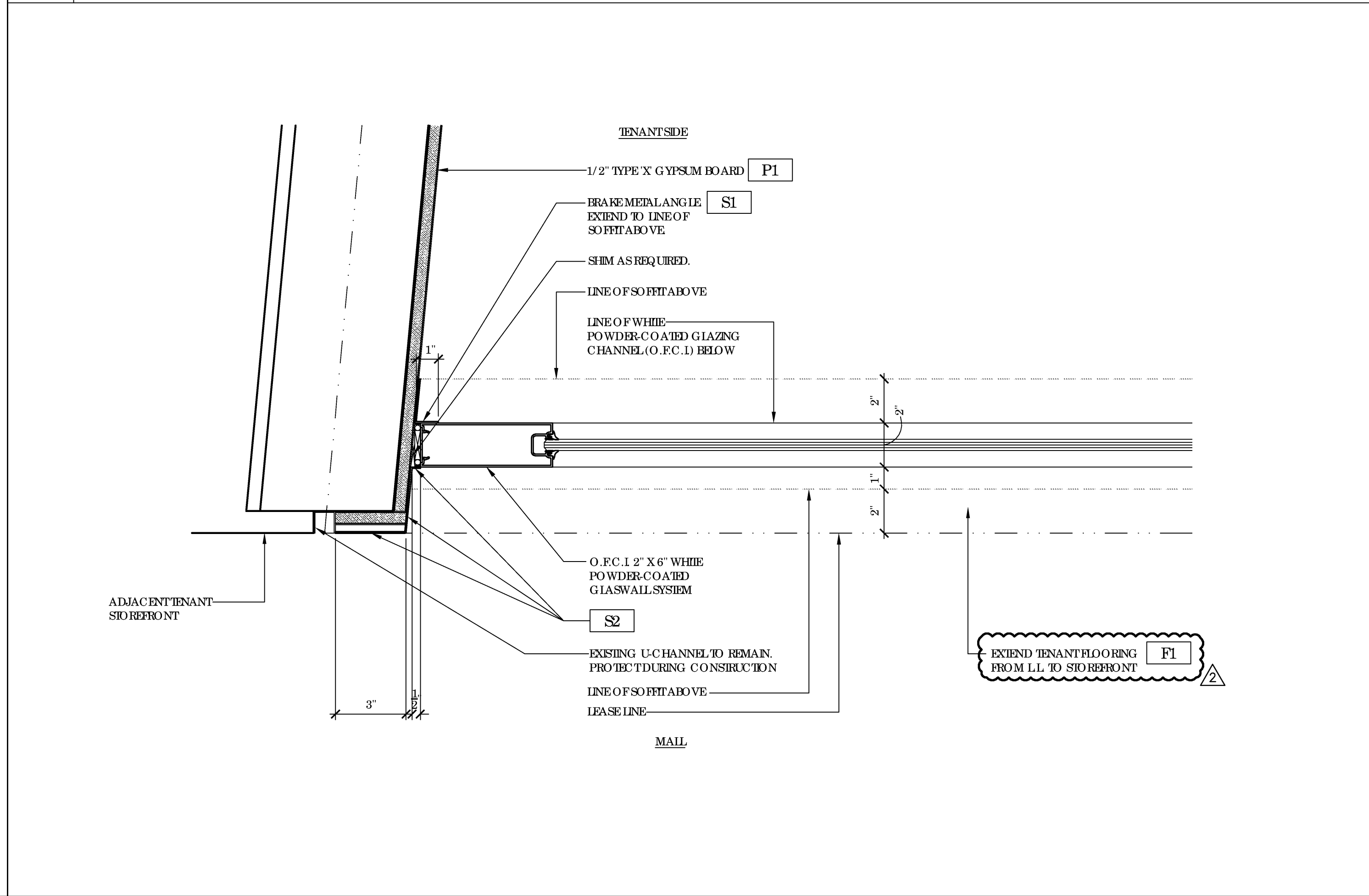

7
PLAN DETAIL
NEUTRAL PIER DETAIL
SCALE 3" = 1'-0"

FREDERICK J. GOGGIA
ARCHITECT, NOAB, FDI
1850 GRAY ROAD, SUITE 300
ST. LOUIS, MO 63146
PH: (314) 415-2400 FAX: (314) 415-2300
www.fjg.com

charlotte
russe

UNIVERSITY TOWN CENTER
140 UNIVERSITY TOWN CENTER DRIVE - SUITE #20
SAPASOTA, FL 34243
SPACE # 210 STORE # 786

REV	DATE	DESCRIPTION
1	07/28/14	ISSUE TO PERMIT
2	07/28/14	OWNER
3	10/06/14	ISSUE TO BID
4	07/28/14	ELITE CONSTRUCTION GROUP
5	07/28/14	PHONE: 727-283-0712
6	07/28/14	RETRACTED BY 10 PERCENT SCALE
7	07/28/14	NOT BE SUBJECT OF MAINTENANCE

PROJECT NO: 14084
DRAWN BY: LAT
CHECKED BY: CSW
ISSUE DATE: 07/28/14
STOREFRONT DETAILS

A3.2